



SCRAP GRAPPLE FORK



FEATURES:

- Designed for skid steers and loaders with the universal mount
- The Scrap Grapple Fork is outfitted with two independent grapple arms that are ideal for safe and efficient handling of uneven loads like brush & debris
- The unit's heavy duty construction makes it an excellent performer in the most in demanding conditions
- The fork tines are constructed using 2" x 2" solid steel
- Grapple tines allows operator to easily separate debris from the dirt
- Bucket sides are swept to accommodate uneven loads
- Available in widths from 62 to 86"
- Powered by two 2-1/2" rams with 1-1/4" diameter shafts
- Bucket back, bottom and sides are made from 1/4" plate
- 3/8" x 2-1/2" bucket side cutting edges
- 1/2" x 2-1/2" bucket wear plates
- 1-1/4" pivot points with serviceable pins
- 1/2" plate laser cut grapple tines
- 1/4" plate protective ram guards
- Durable black paint finish

OPEN VIEW

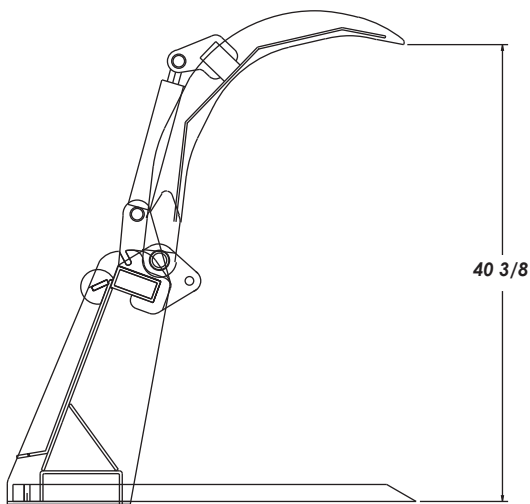

CLOSED VIEW

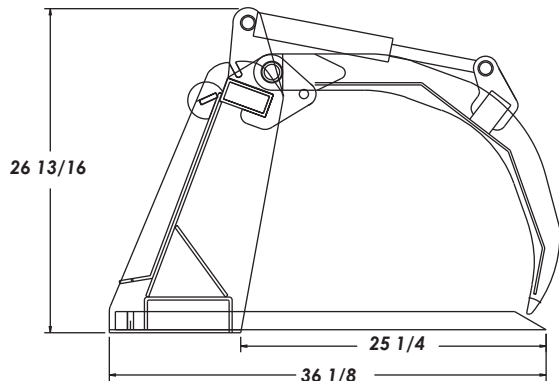

SPECIFICATIONS:

Model #	Bucket Width	Open Height	Bucket Depth	# of Fork Tines	Approx. Weight
SGF 60	60-5/16"	40.1	37.5	9	895 lbs.
SGF 68	67-5/16"	40.1	37.5	10	922 lbs.
SGF 74	74-5/16"	40.1	37.5	11	958 lbs.
SGF 80	81-5/16"	40.1	37.5	12	992 lbs.
SGF 88	88-5/16"	40.1	37.5	13	1016 lbs.

* The above numbers reflect the weight of the implement. Please refer to your owners manual of your skid steer or loader for lift capacities.



GRIDLOCK
Manufacturing Technique

This product features our Grid Lock manufacturing technique that allows for increased strength with less overall weight.



All products are subject to change without notice or liability.

Toll Free: 1-877-947-2882
www.conterraindustries.com

Box 59, Rockyford, Alberta Canada T0J 2R0
Ph: (403) 947-2882 Fax: (403) 947-2892

D6