



SCRAP GRAPPLE BUCKET



FEATURES:

- Designed for skid steers and loaders with the universal mount
- The Scrap Grapple Bucket is outfitted with two independent grapple arms that are ideal for safe and efficient handling of uneven loads like brush & debris
- The unit's heavy duty construction makes it an excellent performer in the most in demanding conditions
- Swept bucket sides to accommodate uneven loads
- Available in widths from 62 to 86"
- Powered by two 2-1/2" rams with 1-1/4" diameter shafts
- Bucket back, bottom and sides are made from 1/4" plate
- 3/8" x 2-1/2" bucket side cutting edges
- 1/2" x 2-1/2" bucket wear plates
- 1-1/4" pivot points with serviceable pins
- 1/2" plate laser cut grapple tines
- 1/4" plate protective ram guards
- Available with either a bolt on cutting edge or large style teeth
- Durable black paint finish

OPEN VIEW

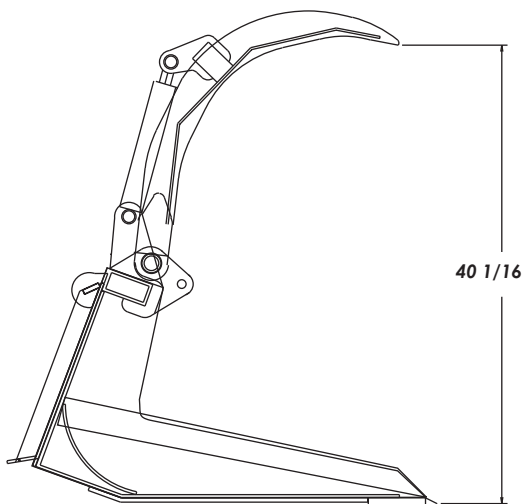

CLOSED VIEW

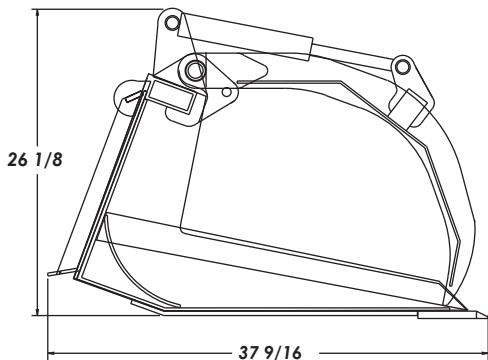

SPECIFICATIONS:

Model #	Bucket Width	Open Height	Bucket Depth	Approx. Weight
SGB 62	62-1/4"	40.1	37.5	895 lbs.
SGB 68	68-1/4"	40.1	37.5	922 lbs.
SGB 74	73-3/8"	40.1	37.5	958 lbs.
SGB 80	80-3/16"	40.1	37.5	992 lbs.
SGB 86	85-1/2"	40.1	37.5	1016 lbs.

* The above numbers reflect the weight of the implement. Please refer to your owners manual of your skid steer for lift capacities.



All products are subject to change without notice or liability.

GRIDLOCK
Manufacturing Technique

This product features our Grid Lock manufacturing technique that allows for increased strength with less overall weight.

Toll Free: 1-877-947-2882
www.conterraindustries.com

Box 59, Rockyford, Alberta Canada T0J 2R0
Ph: (403) 947-2882 Fax: (403) 947-2892

D5